

# Cleveland's Doan Brook: The Home of Rock & Roque

*Kristen Buccier*  
*Project Manager*

*Sarah Rehner*  
*Senior Environmental Specialist*

*May 9, 2019*



# NEORSD Stormwater Design & Construction Program

Navigate using the tabs below and by clicking the images to view more details on our completed, current design, and current construction stormwater projects. Zoom in to view satellite imagery and Regional Stormwater System features (e.g. streams, culverts, conduits, etc). Use the "Zoom To" drop down menu to locate your watershed.

- All Projects
- Design
- Construction
- Complete

4

## Doan Brook Stream Bank Stabilization



Project Name: Doan Brook Stream Bank Stabilization

Community: Cleveland

Watershed Team Leader: [Jeff Jowett](#)

Watershed: Lake Erie Tributary

Subwatershed: Doan Brook

Summary: The project will stabilize and rehabilitate approximately 1,000-feet of Doan Brook

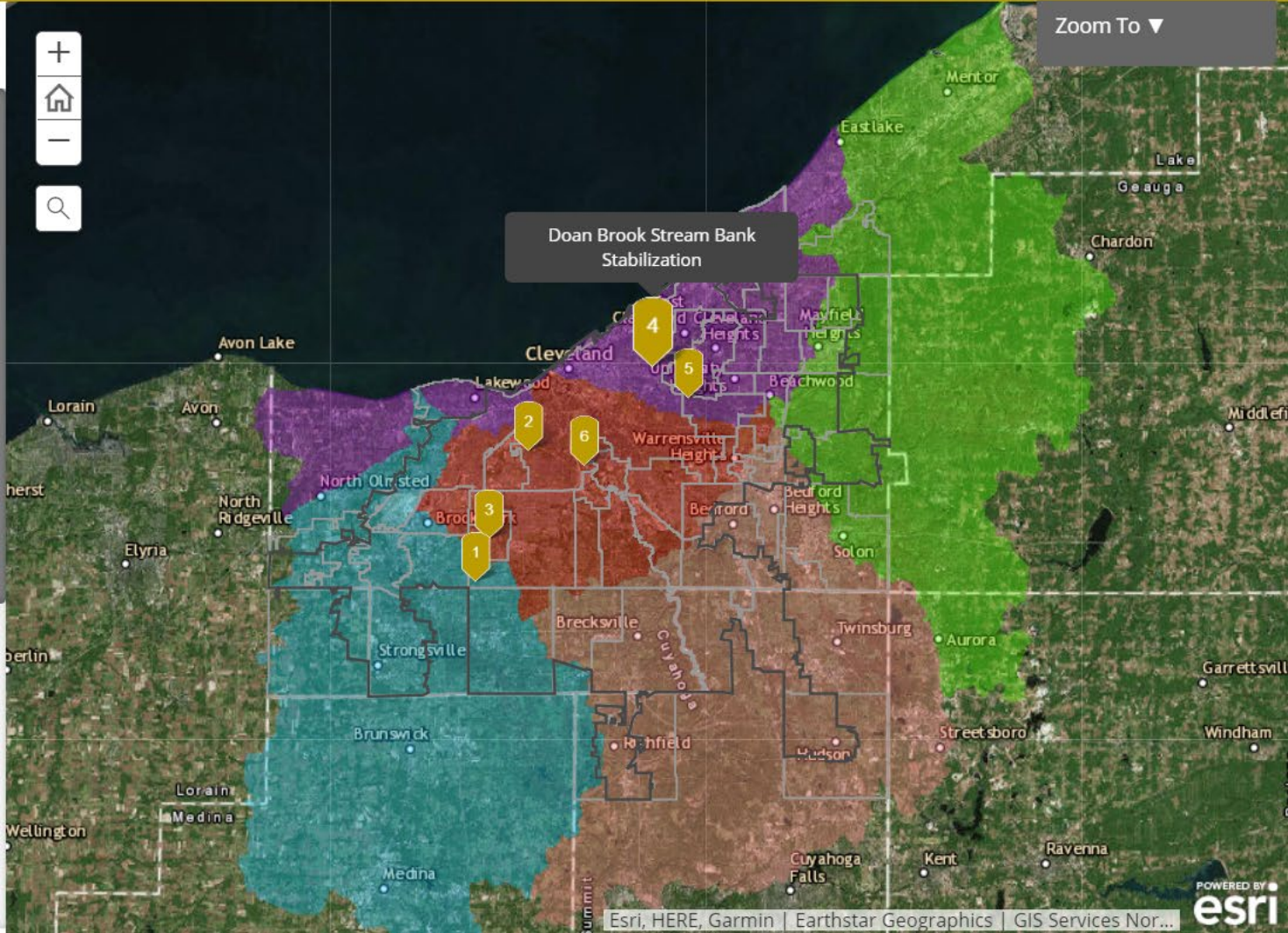

<https://www.neorsd.org/business-home/stormwater-construction-plan/>

















NATIVE TREE & SHRUB BUFFER

LOW NATIVE MEADOW

LOW NATIVE MEADOW

LIVE STAKING ALONG BANKS

LAWN RESTORATION WHERE DISTURBED

EXISTING TREES & LAWN

LOW RIPARIAN TERRACE (PLUG & SEED MIX)

MLK PROJECT (BY OTHERS)

NORD FAMILY GREENWAY (BY OTHERS)





Source: Cleveland Museum of Art



# Doan Brook Enhancement Project

- Rockefeller Park and Cleveland Cultural Gardens Historic District
- Permitting
  - Emphasis on wall replacement
  - Protection of contributing trees
  - Liberty Oaks



**Northeast Ohio  
Regional Sewer District**



# Ohio Historic Preservation Office Review

- Within 1,000 foot buffer of project site:
  - 23 Historic Properties
  - 3 National Register Listings
  - 7 National Register Boundaries

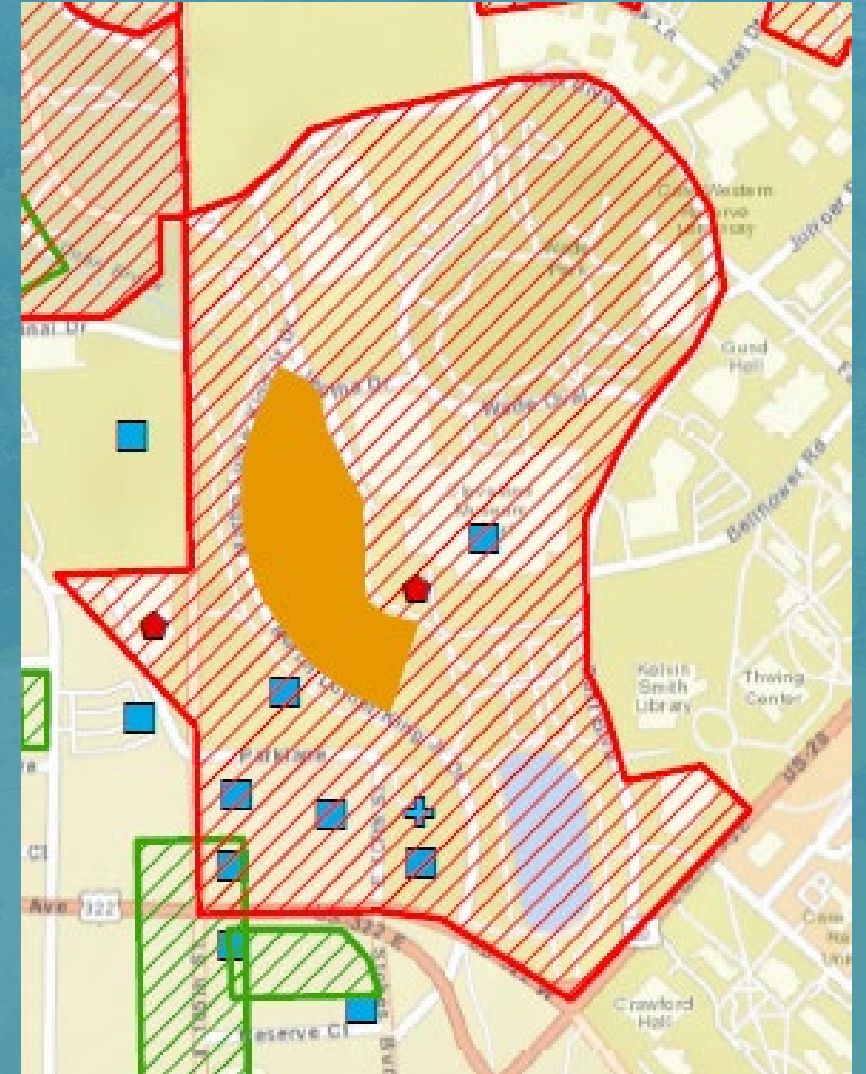





Magnolia-Wade Park

Rockefeller Park

Wade Park

Mather Flora College

Stone

Euclid Heights

Newton Avenue

East 89th Street









Liberty Oak Trees



# Section 106 Approach

- Literature Review
- Review data with historical consultant - Lawhon
- Identified potential concerns
- Held Pre-Application call with SHPO & USACE
- Conducted Phase I Cultural Resources Survey
- Provided all information to USACE with NWP application





# Phase I Cultural Resources Survey

- Area of Potential Effects (APE)
- The entire project area was found to be disturbed
- No archeological resources were identified
- Neither sandstone walls or contributing trees were identified in the National Register of Historic Places (NRHP) nomination form

## **PHASE I CULTURAL RESOURCES SURVEY** *Doan Brook Streambank Stabilization* *Cuyahoga County, Ohio* *L&A Project No: 17-0239*



*Prepared by:*  
**Lawhon & Associates, Inc.**  
1441 King Avenue  
Columbus, Ohio 43212  
July 26, 2017





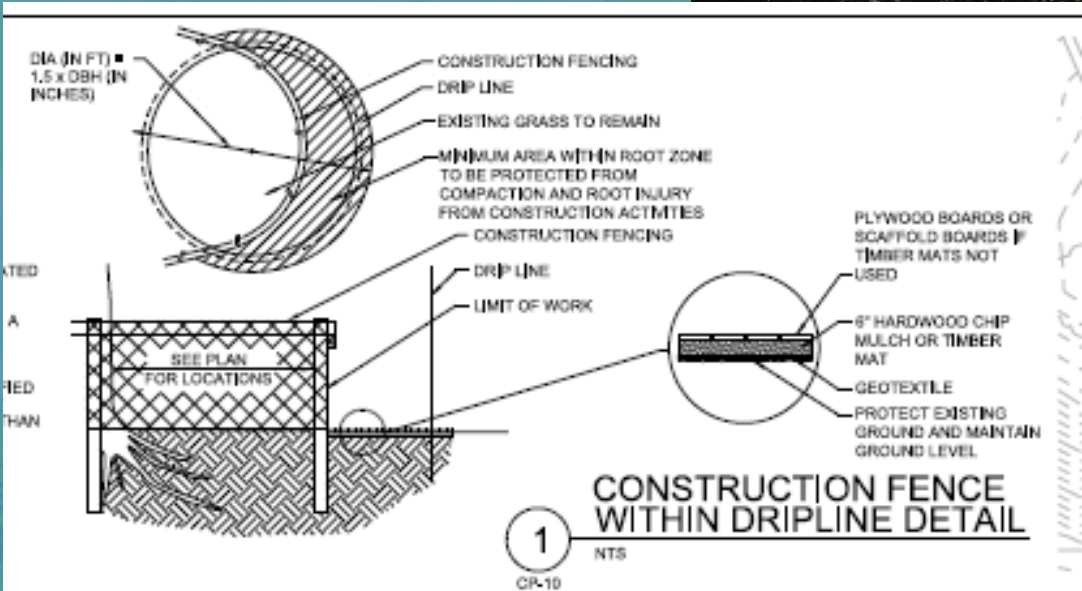
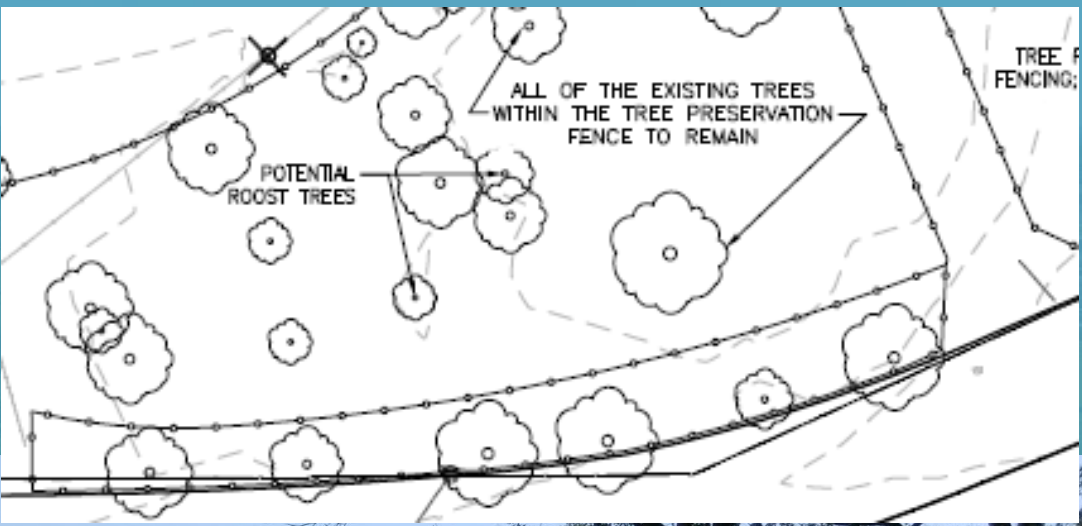
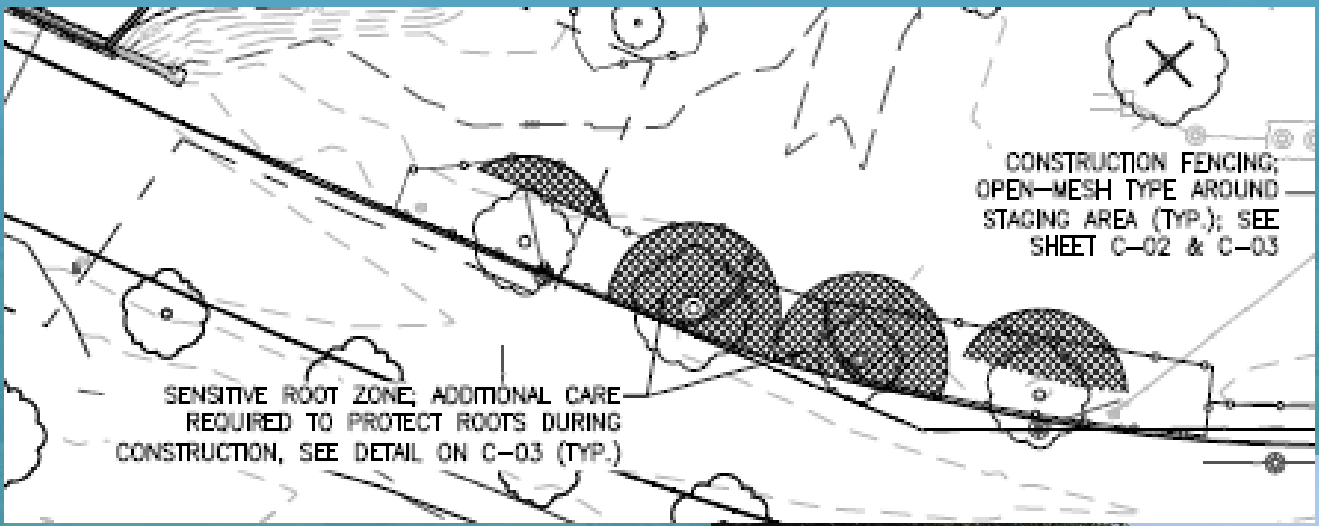











# 2018 Rock Haul





# 2018 Rock Haul





# 2018 Rock Haul Induction Ceremony







April 2019





Remaining Sandstone



# The Discovery!

- Stripping topsoil for an access road led to the discovery of a “foundation and railroad track”
- Contractor stopped work in the area immediately and the Construction Supervisor notified the Project Manager
- Lawhon was onsite the next day, and had already determined it was likely roque courts based off of a historic Hopkins Atlas













Lynn, MA



Norwich, CT



Photographs from Spalding 1906



**Northeast Ohio  
Regional Sewer District**



# What is roque?

<https://www.youtube.com/watch?v=B3sq3-ikAgc>



**Northeast Ohio  
Regional Sewer District**



@neorsd



# Modern Day Roque References

- 1960s: Last publication of rule updates
- 1972: Less than 500 active players in U.S.
- 1977: Steven King's *The Shining*
  - Jack Torrence's use of a roque mallet
- Today: Still going strong in Angelica, NY!



Scale 1MM West to an Inch



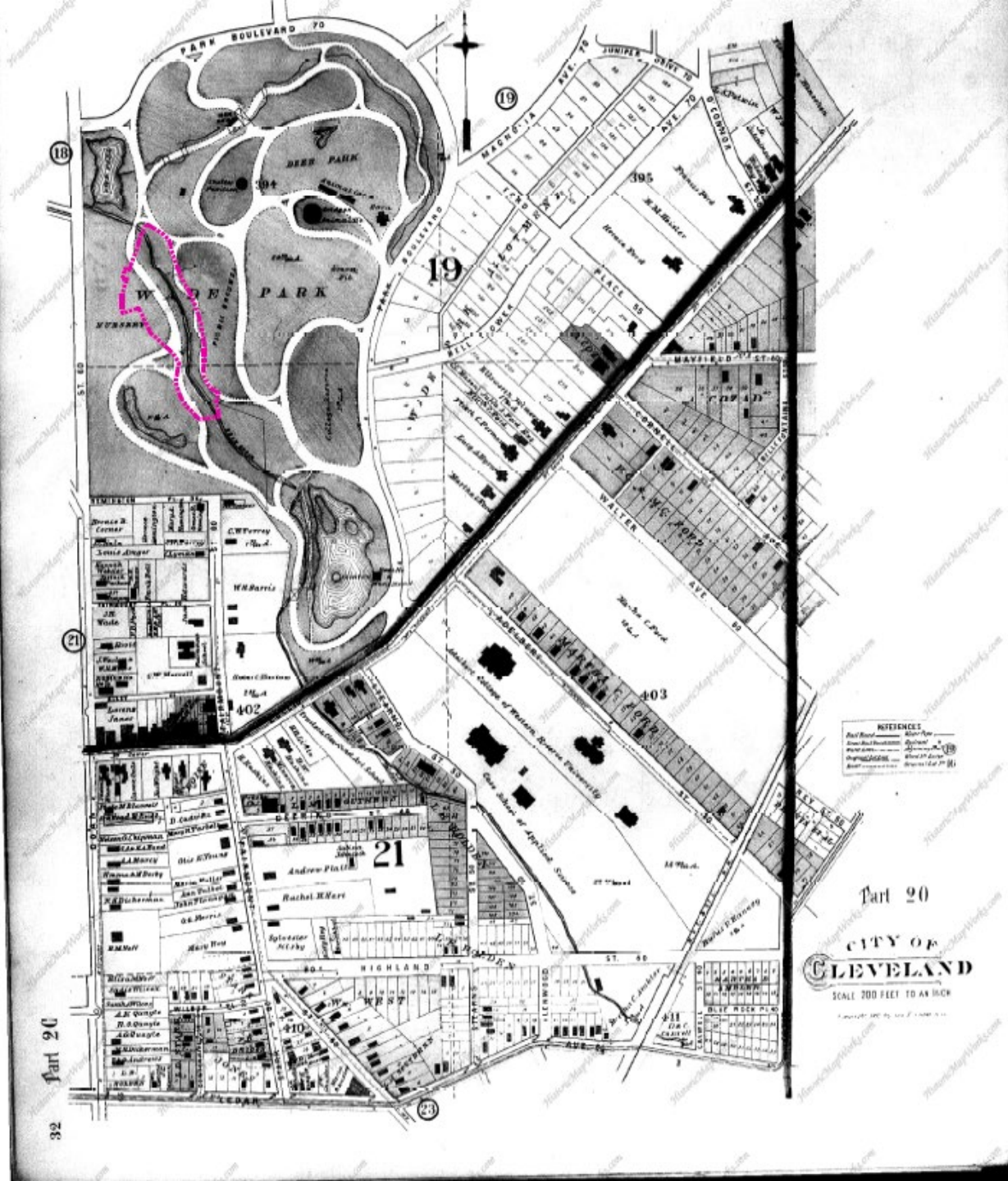





Northeast  
Regional



@neorsd



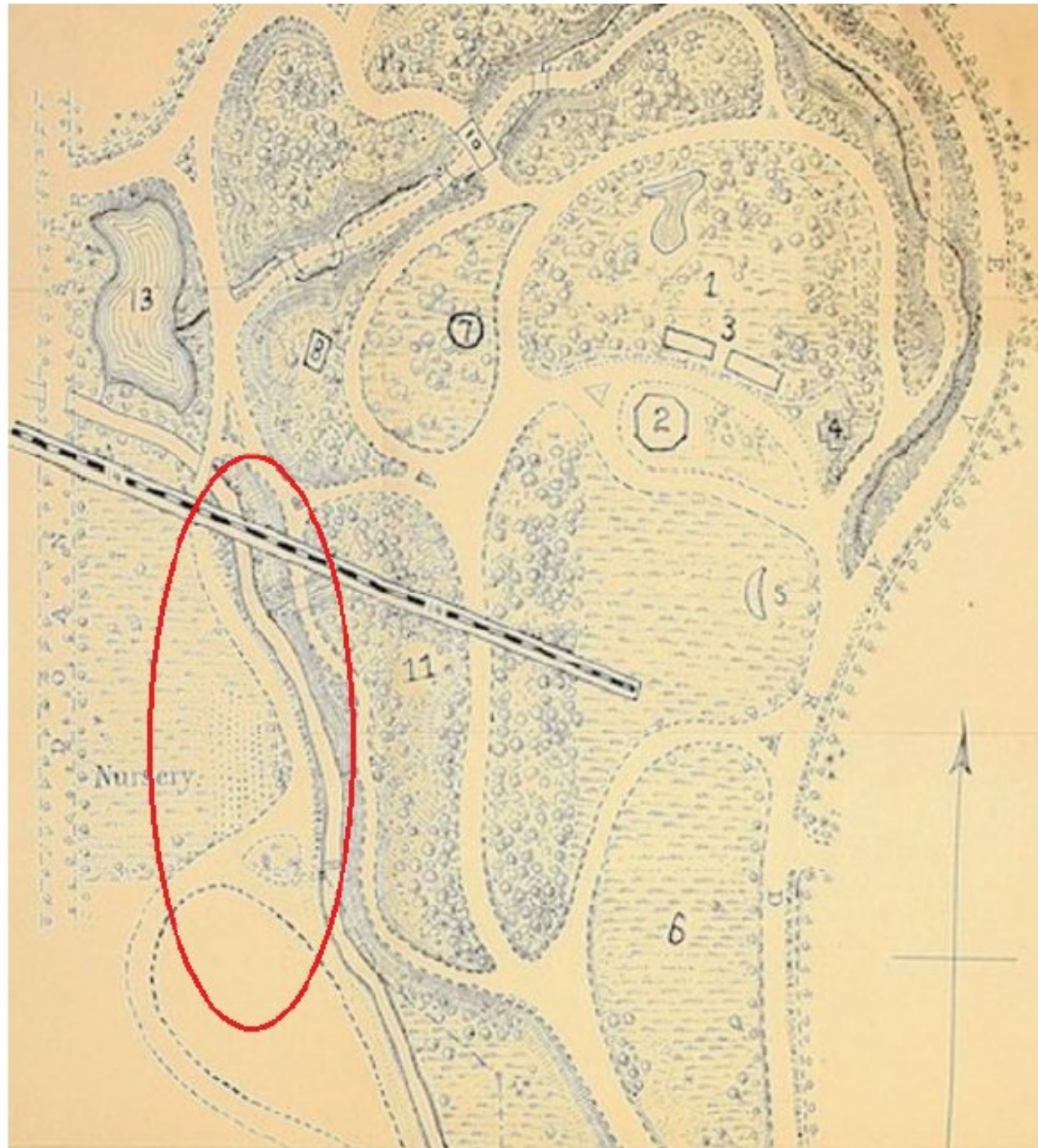

Northeast Ohio  
Regional Sewer Dis



@neorsd





Southern end of project area

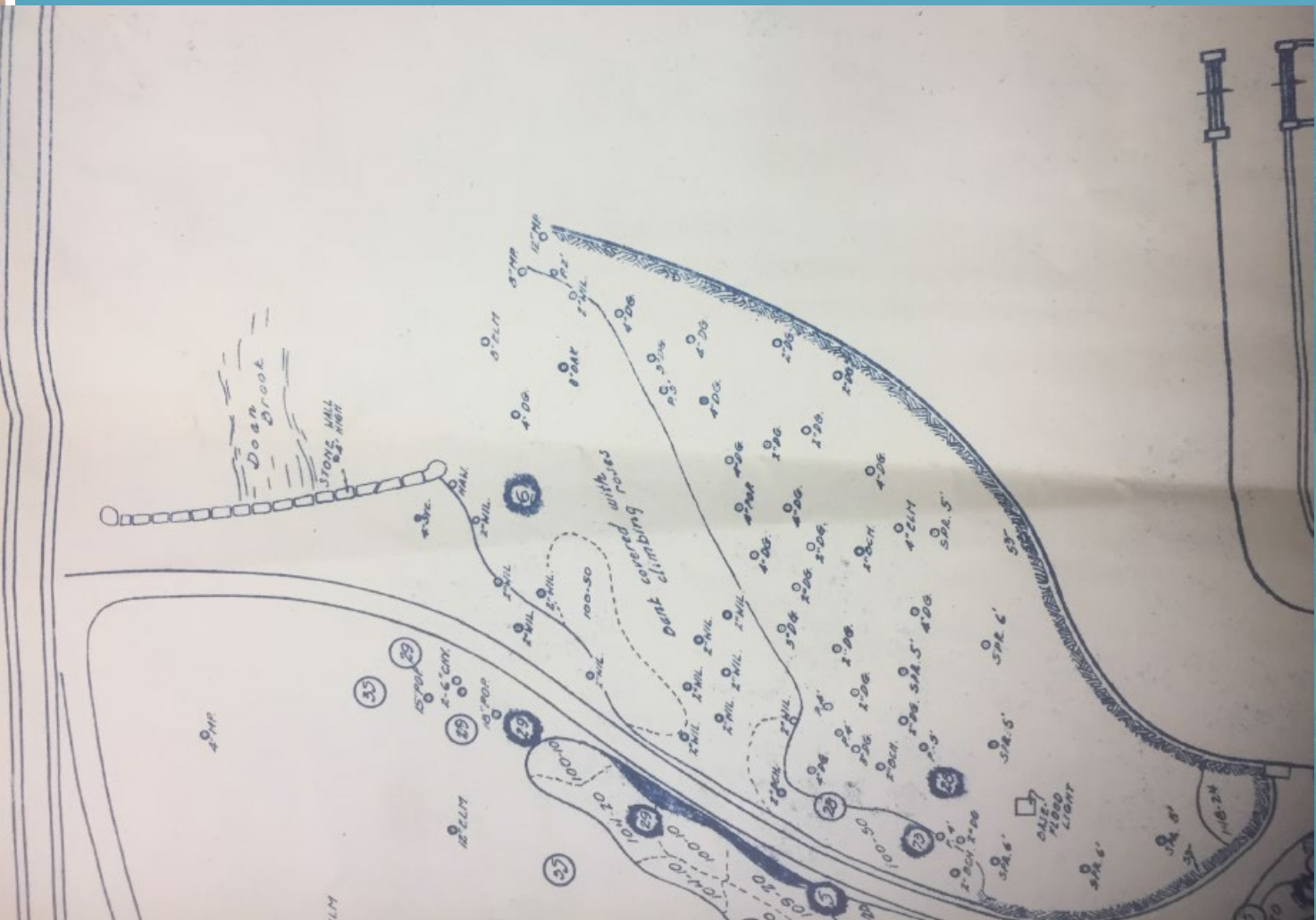

@neorsd



**Legend**

- Exposed Court
- Destroyed
- Unexposed Court

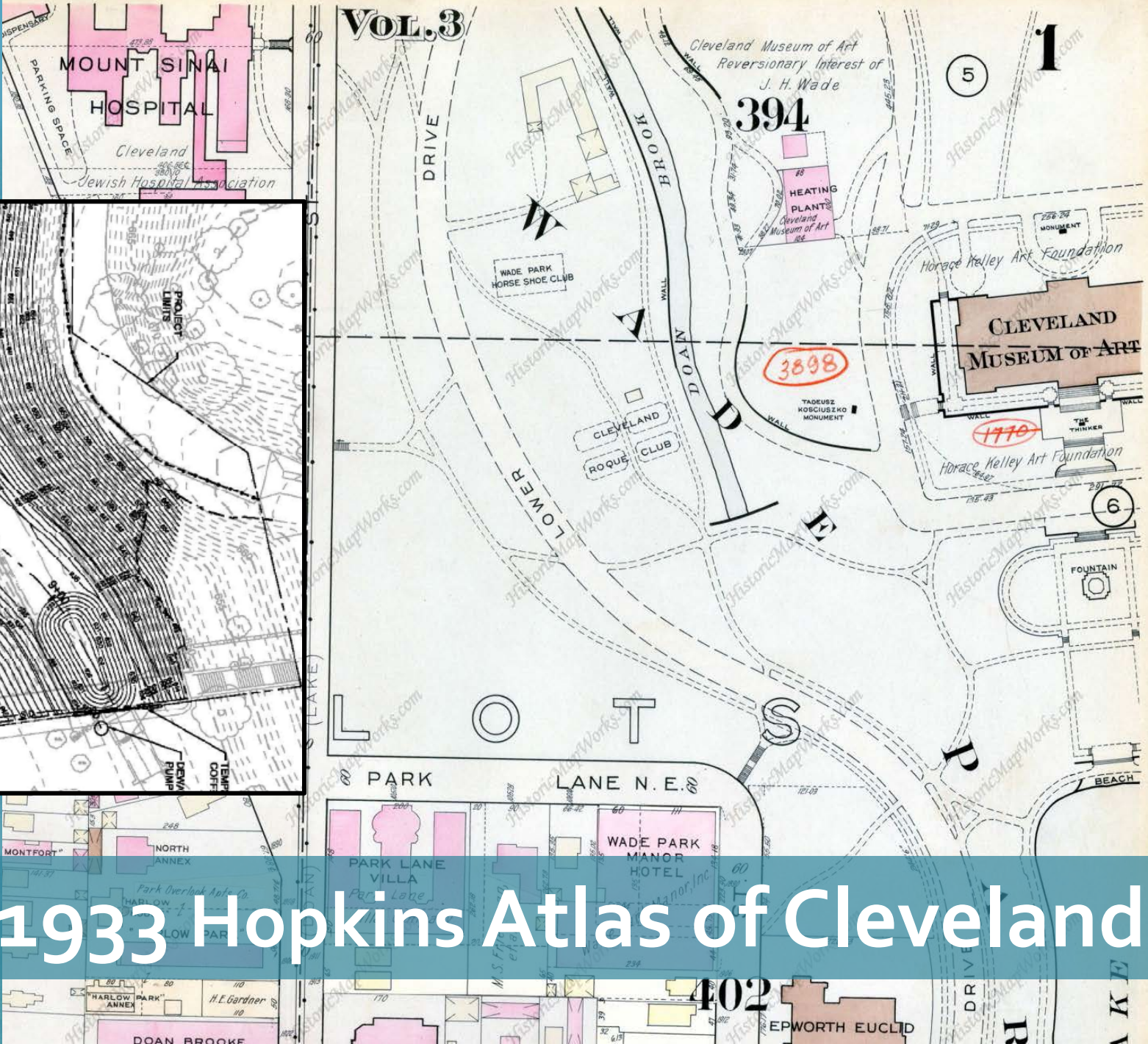
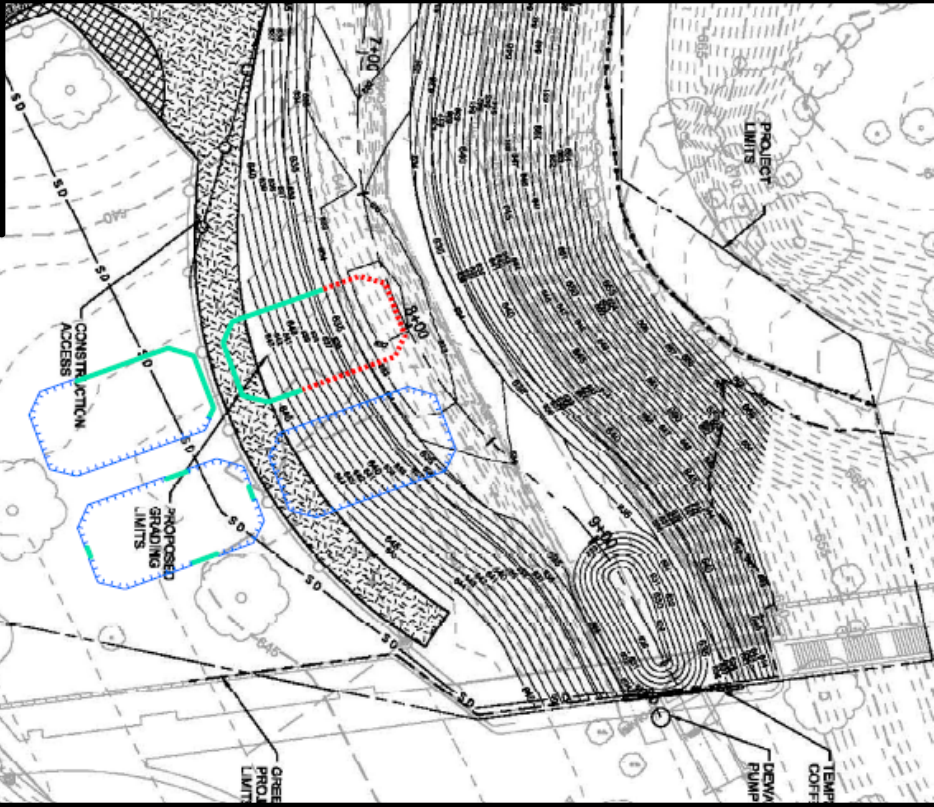



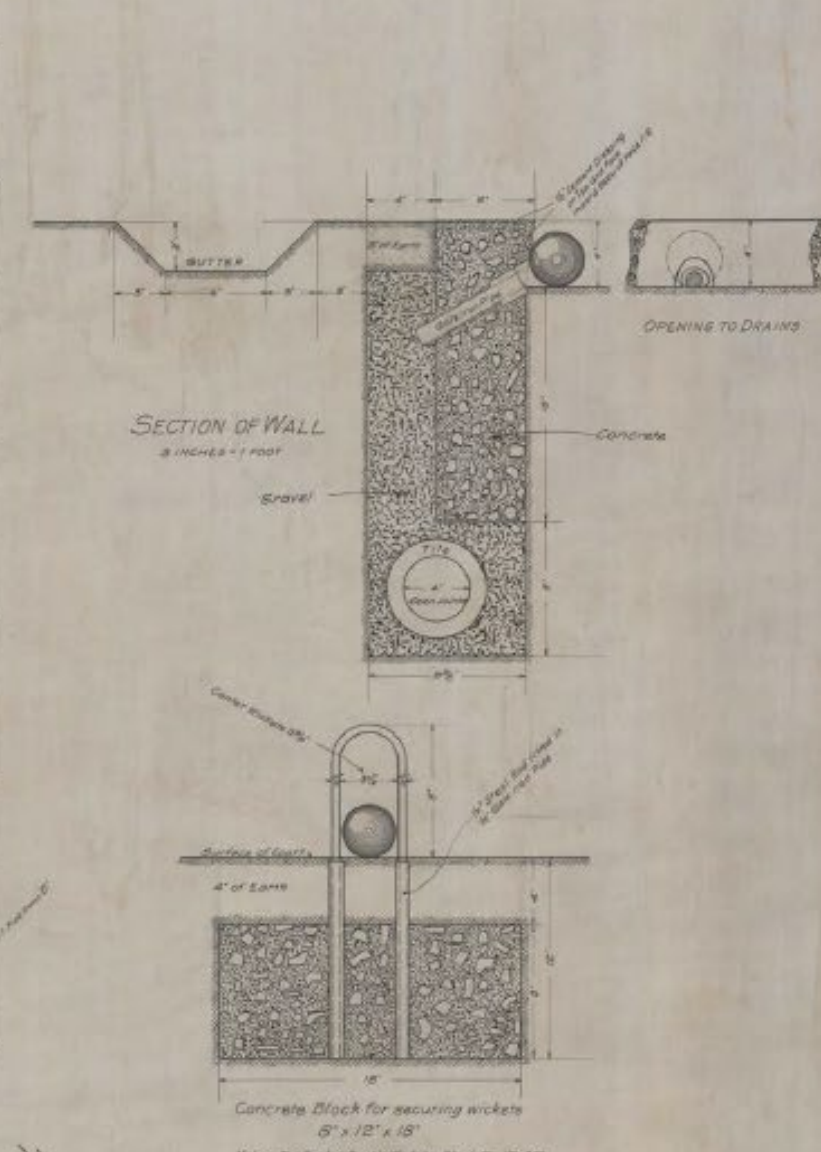

PLAN OF DOUBLE ROQUE COURT  
IN WADE PARK  
SCALES AS NOTED

Robb  
CHIEF ENGINEER

*Camfield Ohio April 1940*



# Unanticipated Discovery Approach

- Notified SHPO and USACE by phone as soon as we knew what we were looking at
- Followed up with an email and photolog
- Lawhon drafted a post-review discovery letter explaining what was found, what the significance was and what we proposed to do
- Documented and photographed the findings
- Preserved a portion of the rogue court and delivered it to SHPO for their Ohio Champion of Sports Exhibit
- Amended the MOA









## A LOST SPORT FOUND

### ROQUE

In the summer of 2018, a construction crew restoring a stream bank near the Cleveland Museum of Art uncovered what looked like concrete curbs. They called in a team of archaeologists who determined that they were actually the boundary walls of a court used for a sport called roque. First played in the 1800s, this game combines croquet and billiards. It became popular in Ohio in the early 1900s. This find was a great example of how historical work informs modern development.

Section 106 of the National Historic Preservation Act requires that federal agencies assess how their projects might affect historic properties. The Cleveland Museum of Art was one such project. By finding historic structures and preserving these innovative stories from the past, the Ohio History Connection, preserved a piece of the city's history so we may learn a little more about it. Perhaps we can even play roque one day.



Ohio Champion of Sports Exhibit  
Ohio History Center



# Lessons Learned

- Incorporating historical materials into new construction is difficult
- Reserve some consulting budget for unanticipated discoveries during construction



# Thank You!

Kristen Buccier

[buccierk@neorsd.org](mailto:buccierk@neorsd.org)

Sarah Rehner

[rehners@neorsd.org](mailto:rehners@neorsd.org)

